

BULLETIN 5110 AC POWER, DC OPERATED
BULLETIN 5210 DC POWER, DC OPERATED

NOTE: WHEN ORDERING PARTS, FURNISH THE FOLLOWING INFORMATION
1. BULLETIN NUMBER, NEMA SIZE & SERIAL NUMBER
FROM NAMEPLATE
2. PART NUMBER & DESCRIPTION

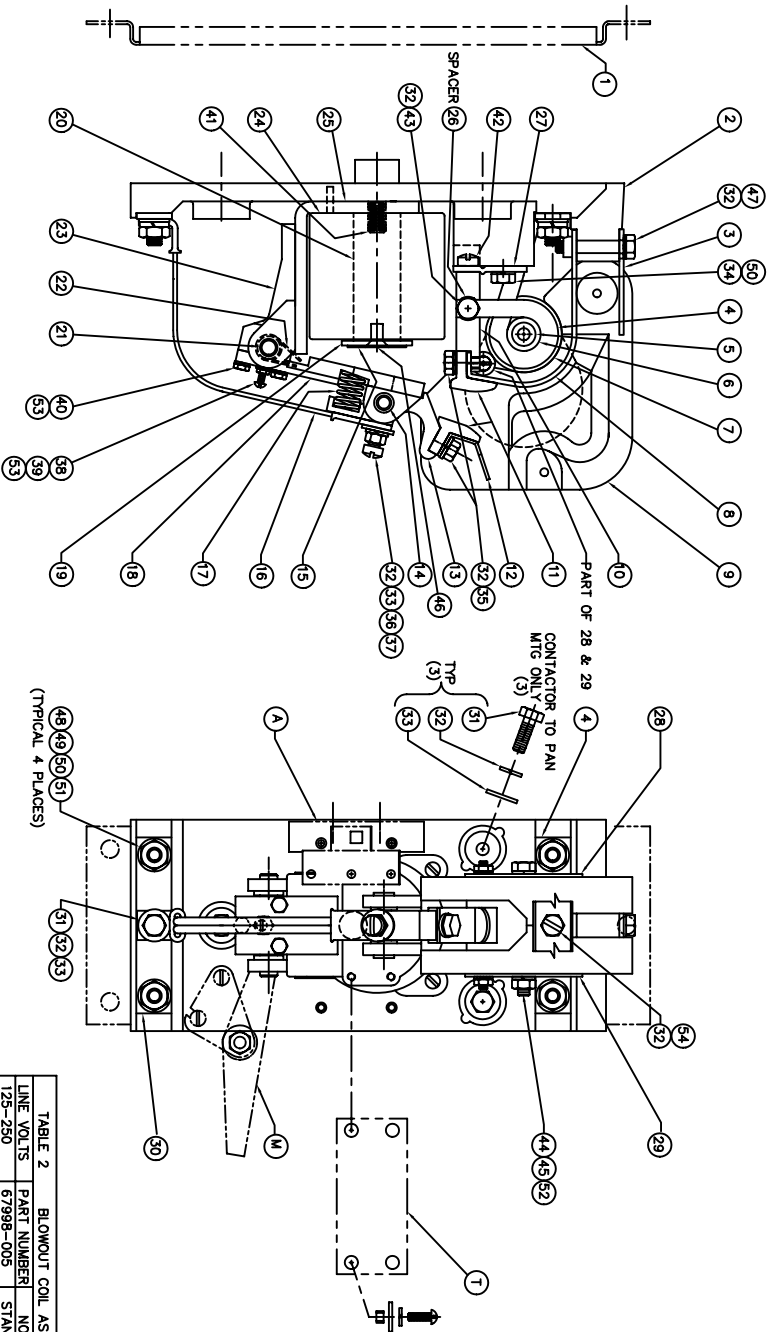

TABLE 2 BLOWOUT COIL ASSEMBLY

LINE VOLTS	PART NUMBER	NOTES
125-250	67998-005	STANDARD
550-575	67998-007	SPECIAL
125-250	67998-011	WELDED (2)

TABLE 1 OPERATING COIL

VOLTS	PART NUMBER	OHMS	COLD
230/250	17359-000	1500	
115/125	17487-000	375	
57.5	17488-000	95	
185	18907-000	1225	
75	19912-000	165	
48	19901-000	76	
36	19905-000	46	
30	19913-000	30	
24	19900-000	19	
18	20000-000	11.5	
12	17489-000	4.8	
8	67892-000	1.7	

ITEM	DESCRIPTION	NOTES	QTY PER HOLE	PART NO
1	MOUNTING PAN	(1)	1	68005-001
2	BASE		1	67995-002
3	ARC SHIELD RETAINER		1	59653-100
4	BLOWOUT COIL ASSEMBLY	(2)	1	SEE TABLE 2
5	DC BLOWOUT CORE (SOLID)	(5)	1	66870-033
6	AC BLOWOUT CORE (SLOTTED)	(5)	1	17348-000
7	BLOWOUT INSULATING TUBE		1	16962-000
8	BLOWOUT INSULATING WASHER		2	16951-000
9	BLOWOUT GUARD		1	68034-001
10	ARC SHIELD ASSEMBLY	(2)	1	16973-000
11	STATIONARY CONTACT SUPPORT	(2)	1	58665-001
12	CONTACT TIP (SILVER FACED)	(5)	2	16924-000
13	ARC TRANSFER TIP	(5)	1	68056-001
14	MOVING CONTACT HOLDER		1	59439-001
15	CONTACT HINGE PIN		1	16968-001
16	NON-MAGNETIC SPACER		1	19683-001
17	SHUNT		1	68000-001
18	CONTACT SPRING		1	17395-000
19	ARMATURE ASSEMBLY	(3)	1	59433-000
20	CORE CAP		1	16940-000
21	COIL CORE		1	59664-001
22	ARMATURE HINGE PIN		1	59843-000
23	ARMATURE SPRING		1	59437-000
24	OPERATING COIL		1	59438-001
25	STATOR ASSEMBLY	(3)	1	SEE TABLE 1
26	SPACER-BLOWOUT COIL	(2)	1	59427-000
27	SUPPORT MOUNTING BRACKET	(2)	1	16971-000
28	FLUX PLATE ASSEMBLY-LEFT HAND	(4)	1	16985-000
29	FLUX PLATE ASSEMBLY-RIGHT HAND	(4)	1	16984-000
30	LOWER CONNECTING BUSS		1	67997-002
31	SCREW 1/4-20 X 3/4 HEX HEAD		4	47246-064
32	LOCKWASHER 1/4" SPLIT		10	47252-038
33	WASHER 1/4" FLAT STEEL		5	47250-002
34	SCREW 5/16-18 X 1/2 FL. H CAP. SS.		1	47246-078
35	SCREW 1/4-20 X 5/8 HEX HD. SS.		2	47278-063
36	NUT 1/4-20 STEEL		1	47253-021
37	SCREW 7/8-20 X 1 7/8 FL. HD.		1	47244-149
38	SCREW #10-24 X 5/8 RND HD.		1	47241-127
39	NUT #10-24 STEEL		1	47253-016
40	SCREW #10-24 X 3/4 HEX HD.		3	47246-047
41	STUD 3/8-16 X 1-5/8 LG.		1	66475-014
42	SCREW 5/16-18 X 1/2 FL. H CAP. SS.		1	48624-004
43	SCREW 1/4-20 X 1 1/2 FL. HD. ST. STL.		1	47778-086
44	SCREW 1/4-20 X 2 1/2 HEX HD.		1	47246-073
45	LOCKWASHER 1/4" EXTERNAL TOOTH		2	47303-008
46	SCREW 1/4-20 X 1 1/2 FL. HD. BRASS		1	47656-108
47	SCREW 5/16-18 X 1 1/2 HEX HD.		1	47246-069
48	SCREW 5/16-18 X 3/4 HEX HD.		4	47246-079
49	WASHER 5/16 FLAT STEEL		4	47250-005
50	LOCKWASHER 5/16 SPLIT		5	47252-039
51	NUT 5/16-18 HEX STEEL		4	47253-002
52	NUT 1/4-20 HEX STEEL		1	47253-001
53	LOCK WASHER #10 HEAVY SPLIT		4	47252-065
54	SCREW 1/4-20 X 1 1/2 HEX HD. SLOTTED		1	47245-061

ACCESSORIES

MUST BE ORDERED SEPARATELY - NOT FURNISHED WITH COMPLETE CONTACTOR

A	M	T
AUXILIARY CONTACTS	MECHANICAL INTERLOCK KIT	THE BAR KIT
SINGLE (1 N.O. & 1 N.C.) PART NO. 68011-001	KIT PART NO. 68041-008 SIZE 4" x 4" x 4" ADJUSTABLE INTERLOCK ASSEMBLY	KIT PART NO. 59400-004 FOR STANDARD 5" CONTACTOR SPACING (NOT MANUAL-MAGNETIC DISCONNECT)
DOUBLE (2 N.O. & 1 N.C.) PART NO. 68011-002	FOR STANDARD 5" CONTACTOR SPACING	REPAIR PARTS ON A-58671
INCLUDES OPERATING STRIKER & MTG. HARDWARE	REPAIR PARTS ON A-58671	REPAIR PARTS ON A-59400 PG. 1

NOTES

- COMPLETE CONTACTOR AVAILABLE WITHOUT MOUNTING PAN, TWO-POLE UNIT
- ITEM 4 (TABLE 2) STANDARD, INCLUDES A WELDED TERMINAL BUSS
- INCLUDES HINGE BEARINGS
- INCLUDES SUPPORT BOSS
- SELECT ONE ITEM ONLY (QUANTITIES AS SHOWN)

REV	DATE	BY	DESCRIPTION
J			
I			
H			
G			
F			
E			
D			
C	5-24-00	HR	AUX #68011 WAS 68040
B	07/497	RWD	#42 WAS P/N 47244-160 IN ERROR
A	11/14/95	RWD	REWORK & REV PER ECM 5210-272

LINEAR DIMENSIONS IN INCHES

DATE 12/08/95 DR. FB/JLM

REPAIR PARTS BULL. 5110 & 5210
NEMA SIZE 3 (100 AMP) CONTACTOR
MOULDED BASE & CAST ARMATURE

DRG. NO. RPC-59430-1

1 OF 1